

Stainless Steel Horizontal Multistage Pump



Application

- It is applicable to household water supply, equipment support, pipeline pressurization, garden watering, vegetable greenhouse watering, fish farming and poultry raising, industrial and mining, water supply and drainage of enterprises and high-rise buildings, central air conditioner and centralized heating circulation system, etc.

Pump

- AISI 304 shaft
- Max. liquid temperature: +85°C
- Altitude: up to 1000 m
- Max. suction: 8 m
- Max. inlet pressure: limited by max. operating pressure

Motor

- Motor with copper winding
- Built-in thermal protector for single phase motor
- Insulation class: F
- Protection class: IP55
- Max. ambient temperature: +40°C

Identification Codes

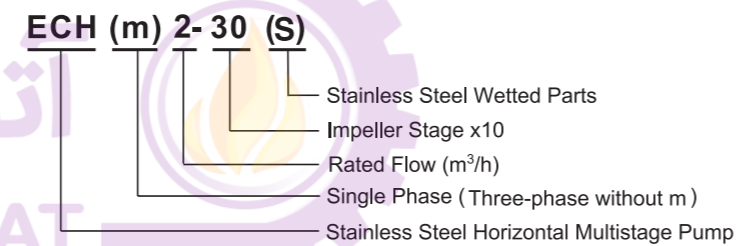

Technical Data

| Model | Power | | Q (m ³ /h) | 0.6 | 1.2 | 1.8 | 2.4 | 3.0 | 3.6 |
|---------------|-------|------|-----------------------|-----------|-----|-----|-----|-----|-----|
| | kW | HP | | | | | | | |
| ECH(m)2-20(S) | 0.37 | 0.5 | H (m) | 16 | 15 | 13 | 12 | 10 | 8 |
| ECH(m)2-30(S) | 0.37 | 0.5 | | 24 | 22 | 20 | 18 | 16 | 12 |
| ECH(m)2-40(S) | 0.55 | 0.75 | | 33 | 30 | 26 | 24 | 21 | 16 |
| ECH(m)2-50(S) | 0.55 | 0.75 | | 40 | 37 | 33 | 30 | 24 | 19 |
| ECH(m)2-60(S) | 0.75 | 1.0 | | 50 | 45 | 40 | 36 | 30 | 23 |
| | | | | Q (l/min) | 10 | 20 | 30 | 40 | 50 |

Dimension

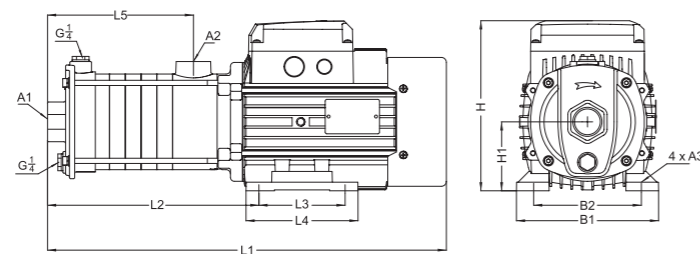

| Model | L1 | L2 | L3 | L4 | L5 | B1 | B2 | H | H1 | A1 | A2 | A3 |
|---------------|-------|-------|----|-----|-------|-----|-----|-------|----|----|----|----|
| ECH(m)2-20(S) | 344.5 | 165.5 | 90 | 110 | 98.5 | 137 | 109 | 176.5 | 71 | G1 | G1 | Φ7 |
| ECH(m)2-30(S) | 362.5 | 183.5 | 90 | 110 | 116.5 | 137 | 109 | 176.5 | 71 | G1 | G1 | Φ7 |
| ECH(m)2-40(S) | 380.5 | 201.5 | 90 | 100 | 134.5 | 137 | 109 | 176.5 | 71 | G1 | G1 | Φ7 |
| ECH(m)2-50(S) | 399.5 | 220.5 | 90 | 110 | 153.5 | 137 | 109 | 176.5 | 71 | G1 | G1 | Φ7 |
| ECH(m)2-60(S) | 417.5 | 238.5 | 90 | 110 | 171.5 | 137 | 109 | 176.5 | 71 | G1 | G1 | Φ7 |

Hydraulic Performance Curves

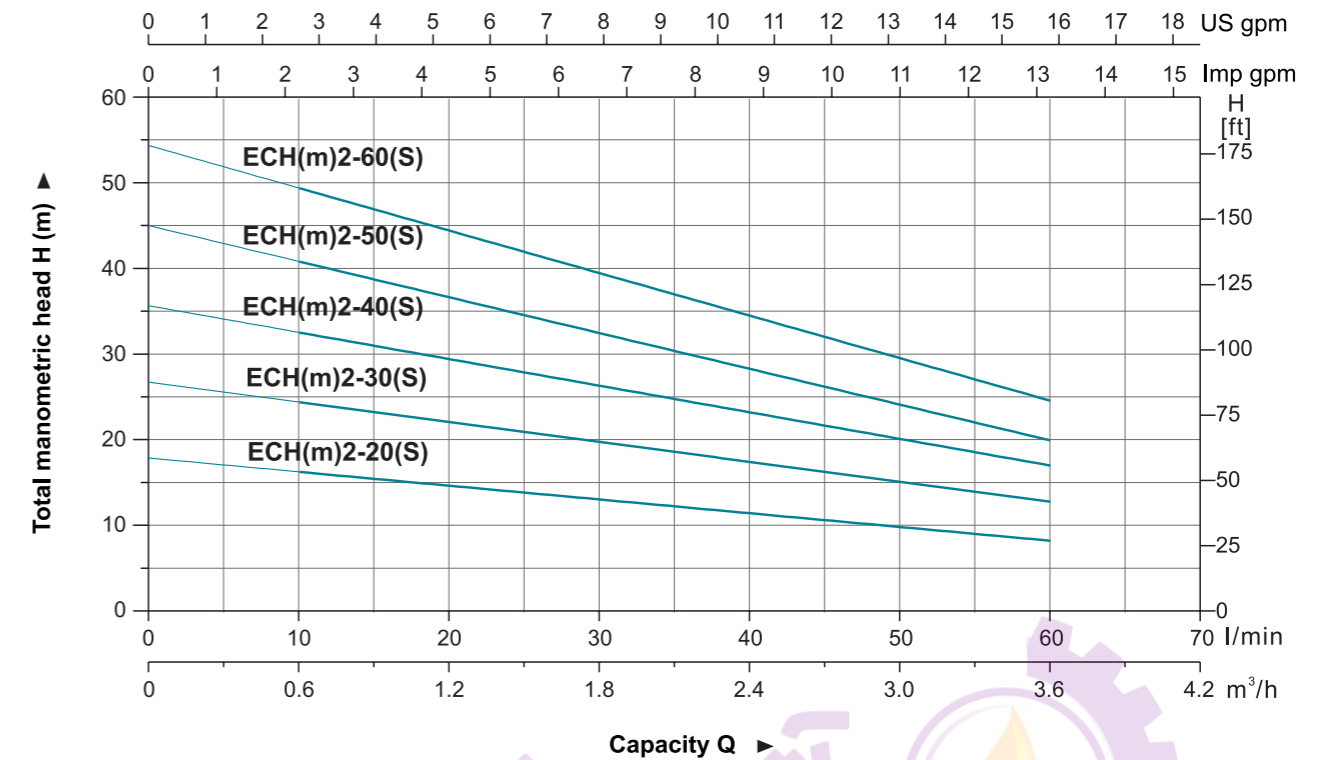

Materials Table

| No. | Part | Material |
|-----|-----------------|--------------------|
| 1 | Fan cover | 08F |
| 2 | Fan | PP |
| 3 | Rear cover | ZL 102 |
| 4 | Rotor | |
| 5 | Bearing | |
| 6 | Terminal box | ZL 102 |
| 7 | Stator | |
| 8 | Front cover | Cast iron |
| 9 | Outlet body | Cast iron/AISI 304 |
| 10 | Mechanical seal | Carbon/Ceramic |
| 11 | Diffuser | AISI 304 |
| 12 | Sleeve | AISI 304 |
| 13 | Impeller | AISI 304 |
| 14 | Pump body | Cast iron/AISI 304 |

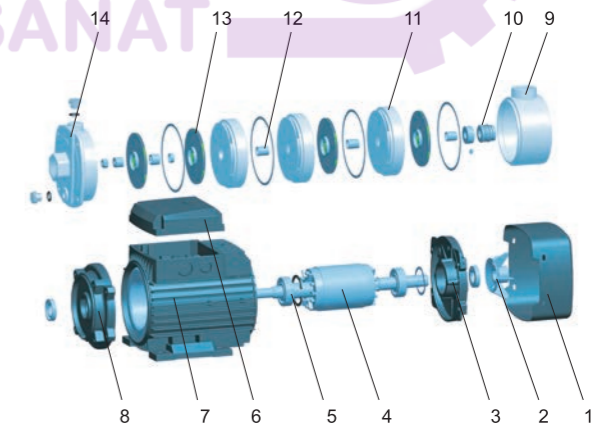

Package Information

| Model | GW (Kgs) | L (mm) | W (mm) | H (mm) | Quantity (PCS/20 TEU) |
|---------------|----------|--------|--------|--------|-----------------------|
| ECH(m)2-20(S) | 11.5 | 420 | 215 | 243 | 1215 |
| ECH(m)2-30(S) | 11.8 | 420 | 215 | 243 | 1215 |
| ECH(m)2-40(S) | 13.2 | 420 | 215 | 243 | 1215 |
| ECH(m)2-50(S) | 13.7 | 455 | 215 | 243 | 1170 |
| ECH(m)2-60(S) | 14.6 | 455 | 215 | 243 | 1170 |



Stainless Steel Horizontal Multistage Pump



ECH

ECHS

Application

- It is applicable to household water supply, equipment support, pipeline pressurization, garden watering, vegetable greenhouse watering, fish farming and poultry raising, industrial and mining, water supply and drainage of enterprises and high-rise buildings, central air conditioner and centralized heating circulation system, etc.

Pump

- AISI 304 shaft
- Max. liquid temperature: +85°C
- Altitude: up to 1000 m
- Max. suction: 8 m
- Max. inlet pressure: limited by max. operating pressure

Motor

- Motor with copper winding
- Built-in thermal protector for single phase motor
- Insulation class: F
- Protection class: IP55
- Max. ambient temperature: +40°C

Identification Codes

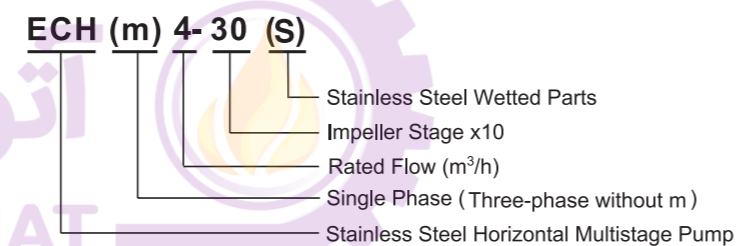

Technical Data

| Model | Power | | Q (m ³ /h) Q (l/min) | 1 | 2 | 3 | 4 | 5 | 6 | 7 |
|---------------|-------|------|------------------------------------|-------|----|----|----|----|----|-----|
| | kW | HP | | H (m) | 17 | 33 | 50 | 67 | 83 | 100 |
| ECH(m)4-20(S) | 0.55 | 0.75 | H (m) | 17 | 16 | 15 | 13 | 12 | 10 | 8 |
| ECH(m)4-30(S) | 0.55 | 0.75 | | 27 | 25 | 23 | 21 | 19 | 16 | 13 |
| ECH(m)4-40(S) | 0.75 | 1.0 | | 36 | 34 | 32 | 28 | 26 | 22 | 17 |
| ECH(m)4-50(S) | 1.1 | 1.5 | | 46 | 43 | 40 | 36 | 33 | 28 | 21 |
| ECH(m)4-60(S) | 1.1 | 1.5 | | 55 | 52 | 48 | 43 | 39 | 33 | 26 |

Dimension

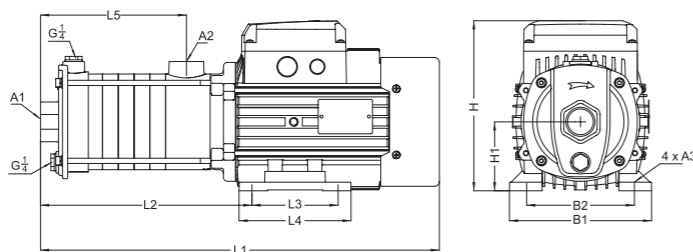

| Model | L1 | L2 | L3 | L4 | L5 | B1 | B2 | H | H1 | A1 | A2 | A3 |
|---------------|-------|-------|-----|-----|-------|-----|-----|-------|----|--------------------------------|----|-----|
| ECH(m)4-20(S) | 354 | 175.5 | 90 | 110 | 108.5 | 137 | 109 | 176.5 | 71 | G1 ¹ / ₄ | G1 | Φ7 |
| ECH(m)4-30(S) | 381.5 | 203 | 90 | 110 | 136 | 137 | 109 | 176.5 | 71 | G1 ¹ / ₄ | G1 | Φ7 |
| ECH(m)4-40(S) | 408.5 | 230 | 90 | 110 | 163 | 137 | 109 | 176.5 | 71 | G1 ¹ / ₄ | G1 | Φ7 |
| ECH(m)4-50(S) | 484 | 266 | 100 | 130 | 190 | 165 | 125 | 204.5 | 80 | G1 ¹ / ₄ | G1 | Φ10 |
| ECH(m)4-60(S) | 511.5 | 293.5 | 100 | 130 | 217.5 | 165 | 125 | 204.5 | 80 | G1 ¹ / ₄ | G1 | Φ10 |

Hydraulic Performance Curves

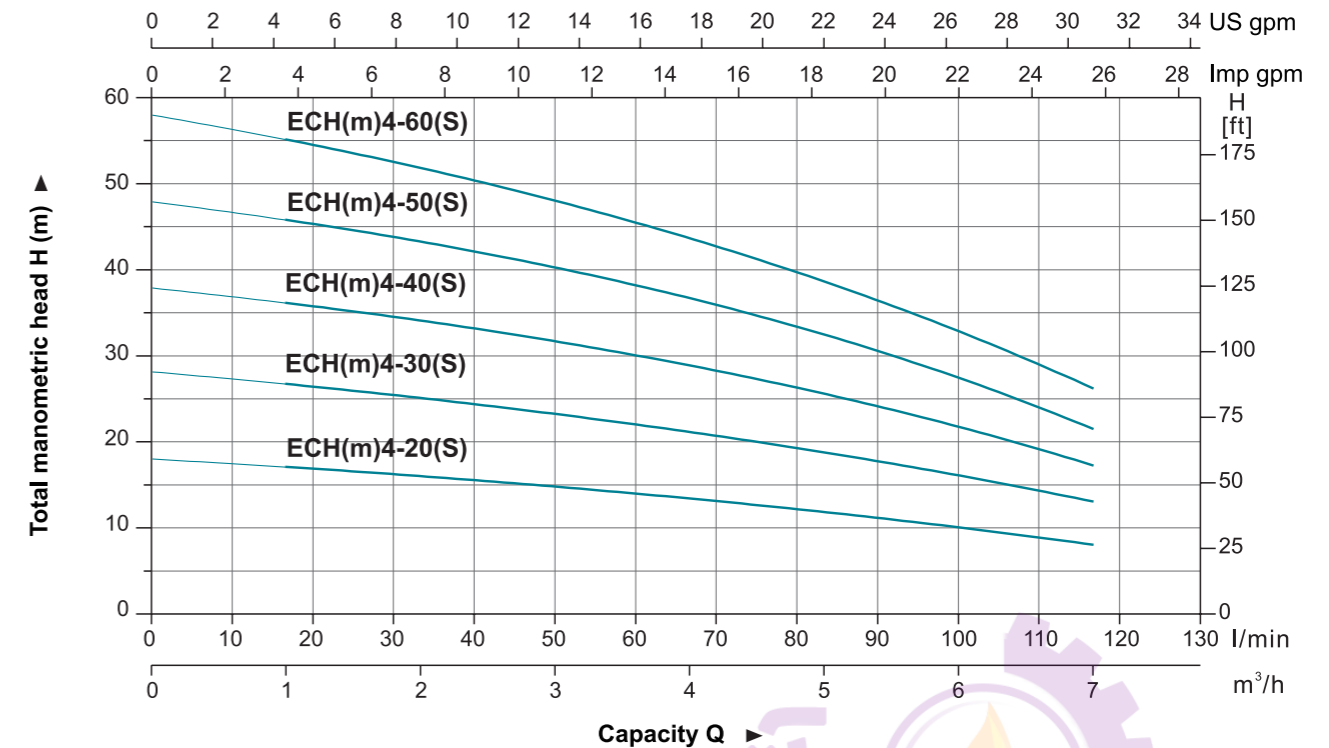

Materials Table

| No. | Part | Material |
|-----|-----------------|--------------------|
| 1 | Fan cover | 08F |
| 2 | Fan | PP |
| 3 | Rear cover | ZL 102 |
| 4 | Rotor | |
| 5 | Bearing | |
| 6 | Terminal box | ZL 102 |
| 7 | Stator | |
| 8 | Front cover | Cast iron |
| 9 | Outlet body | Cast iron/AISI 304 |
| 10 | Mechanical seal | Carbon/Ceramic |
| 11 | Diffuser | AISI 304 |
| 12 | Sleeve | AISI 304 |
| 13 | Impeller | AISI 304 |
| 14 | Pump body | Cast iron/AISI 304 |

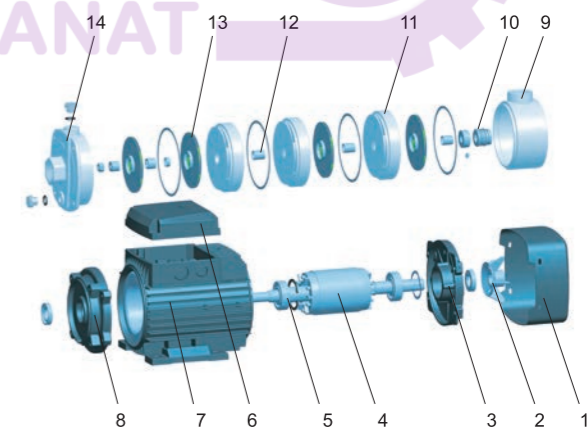

Package Information

| Model | GW (Kgs) | L (mm) | W (mm) | H (mm) | Quantity (PCS/20 TEU) |
|---------------|----------|--------|--------|--------|-----------------------|
| ECH(m)4-20(S) | 13.1 | 420 | 215 | 243 | 1215 |
| ECH(m)4-30(S) | 13.6 | 420 | 215 | 243 | 1215 |
| ECH(m)4-40(S) | 14.7 | 455 | 215 | 243 | 1170 |
| ECH(m)4-50(S) | 21.5 | 548 | 235 | 268 | 800 |
| ECH(m)4-60(S) | 22 | 548 | 235 | 268 | 800 |

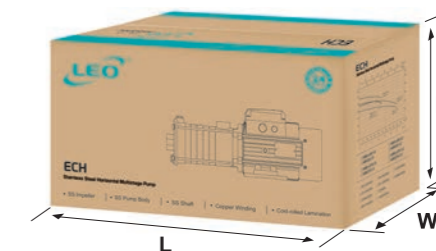



Application

- It is applicable to household water supply, equipment support, pipeline pressurization, garden watering, vegetable greenhouse watering, fish farming and poultry raising, industrial and mining, water supply and drainage of enterprises and high-rise buildings, central air conditioner and centralized heating circulation system, etc.

Pump

- AISI 304 shaft
- Max. liquid temperature: +85°C
- Altitude: up to 1000 m
- Max. suction: 8 m
- Max. inlet pressure: limited by max. operating pressure

Motor

- Motor with copper winding
- Built-in thermal protector for single phase motor
- Insulation class: F
- Protection class: IP55
- Max. ambient temperature: +40°C

Identification Codes

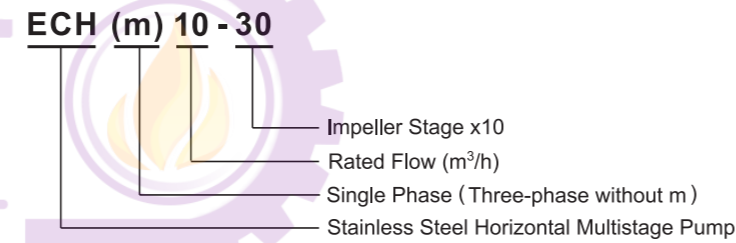

Technical Data

| Model | Power | | Q (m³/h) Q (l/min) | 6 | 7 | 8 | 9 | 10 | 11 | 12 |
|-------------|-------|-----|-----------------------|-------|------|------|------|------|------|------|
| | kW | HP | | H (m) | 100 | 117 | 133 | 150 | 167 | 183 |
| ECH(m)10-10 | 0.75 | 1.0 | H (m) | 9.1 | 8.7 | 8.2 | 7.7 | 6.8 | 5.8 | — |
| ECH(m)10-20 | | | | 17.9 | 17.1 | 16.3 | 15.3 | 14.0 | 12.5 | 10.6 |
| ECH(m)10-30 | 1.1 | 1.5 | | 27.1 | 26.3 | 24.9 | 23.4 | 21.4 | 19.3 | 16.9 |
| ECH(m)10-40 | 1.5 | 2.0 | | 38.6 | 37.6 | 35.9 | 33.9 | 31.2 | 28.2 | 24.6 |
| ECH(m)10-50 | 2.2 | 3.0 | | 47.8 | 46.4 | 44.4 | 42.2 | 39.5 | 35.9 | 31.1 |

Dimension

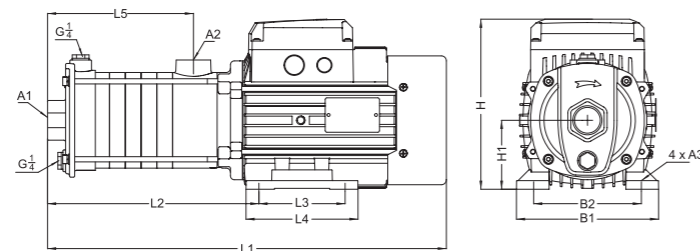

| Model | L1 | L2 | L3 | L4 | L5 | B1 | B2 | H | H1 | A1 | A2 | A3 |
|-------------|-------|-------|-----|-----|-------|-----|-----|-------|----|-----|-----|-----|
| ECH(m)10-10 | 430 | 212 | 100 | 130 | 121 | 165 | 125 | 204.5 | 80 | G1½ | G1¼ | Φ10 |
| ECH(m)10-20 | 430 | 212 | 100 | 130 | 121 | 165 | 125 | 204.5 | 80 | G1½ | G1¼ | Φ10 |
| ECH(m)10-30 | 460.5 | 242.5 | 100 | 130 | 151.5 | 165 | 125 | 504.5 | 80 | G1½ | G1¼ | Φ10 |
| ECH(m)10-40 | 549.5 | 261.5 | 125 | 150 | 182 | 180 | 140 | 217.5 | 90 | G1½ | G1¼ | Φ10 |
| ECH(m)10-50 | 579.5 | 291.5 | 125 | 150 | 212 | 180 | 140 | 217.5 | 90 | G1½ | G1¼ | Φ10 |

Hydraulic Performance Curves

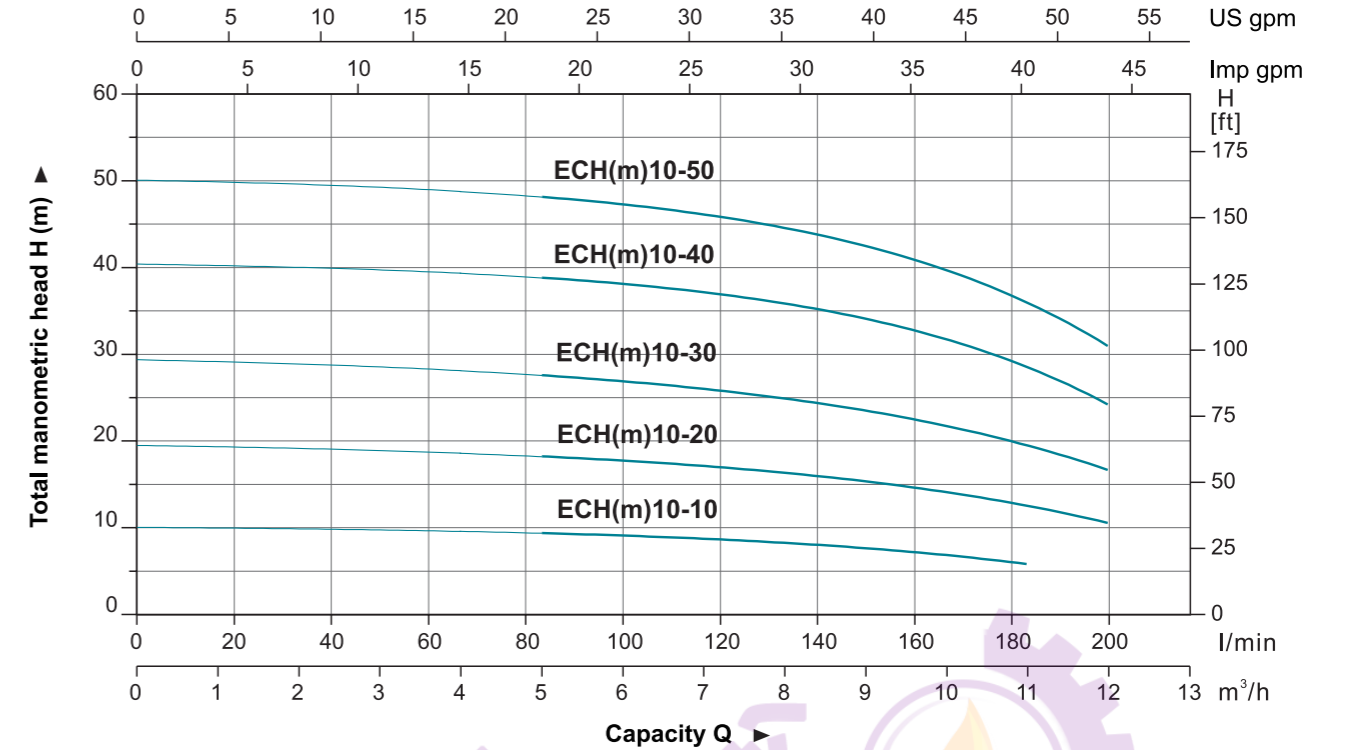

Materials Table

| No. | Part | Material |
|-----|-----------------|----------------|
| 1 | Fan cover | 08F |
| 2 | Fan | PP |
| 3 | Rear cover | ZL 102 |
| 4 | Rotor | |
| 5 | Bearing | |
| 6 | Terminal box | ZL 102 |
| 7 | Stator | |
| 8 | Front cover | Cast iron |
| 9 | Outlet body | Cast iron |
| 10 | Mechanical seal | Carbon/Ceramic |
| 11 | Diffuser | AISI 304 |
| 12 | Sleeve | AISI 304 |
| 13 | Impeller | AISI 304 |
| 14 | Pump body | Cast iron |

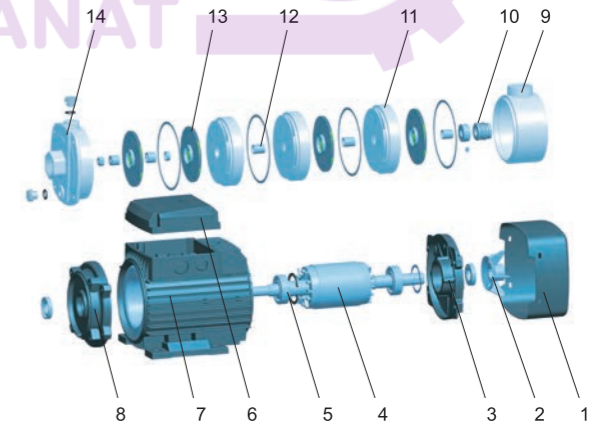

Package Information

| Model | GW (Kgs) | L (mm) | W (mm) | H (mm) | Quantity (PCS/20 TEU) |
|-------------|----------|--------|--------|--------|-----------------------|
| ECH(m)10-10 | 20.7 | 503 | 235 | 268 | 856 |
| ECH(m)10-20 | 20.8 | 503 | 235 | 268 | 856 |
| ECH(m)10-30 | 21.9 | 503 | 235 | 268 | 856 |
| ECH(m)10-40 | 28.2 | 618 | 245 | 283 | 653 |
| ECH(m)10-50 | 30.6 | 618 | 245 | 283 | 653 |



Stainless Steel Horizontal Multistage Pump



Application

- It is applicable to household water supply, equipment support, pipeline pressurization, garden watering, vegetable greenhouse watering, fish farming and poultry raising, industrial and mining, water supply and drainage of enterprises and high-rise buildings, central air conditioner and centralized heating circulation system, etc.

Pump

- AISI 304 shaft
- Max. liquid temperature: +85°C
- Altitude: up to 1000 m
- Max. suction: 8 m
- Max. inlet pressure: limited by max. operating pressure

Motor

- Motor with copper winding
- Built-in thermal protector for single phase motor
- Insulation class: F
- Protection class: IP55
- Max. ambient temperature: +40°C

Identification Codes

ECH (m) 15 - 20

- Impeller Stage x10
- Rated Flow (m³/h)
- Single Phase (Three-phase without m)
- Stainless Steel Horizontal Multistage Pump

Technical Data

| Model | Power | | Q (m ³ /h) | 9 | 12 | 15 | 18 | 21 |
|-------------|-------|-----|-----------------------|------|------|------|------|------|
| | kW | HP | | | | | | |
| ECH(m)15-10 | 1.1 | 1.5 | H (m) | 12.4 | 11.6 | 10.6 | 9.4 | 8.2 |
| ECH(m)15-20 | 2.2 | 3 | | 25.6 | 24.1 | 22.7 | 21.1 | 18.8 |
| ECH15-30 | 3.0 | 4 | | 38.7 | 36.9 | 34.9 | 31.9 | 28.5 |
| ECH15-40 | 4.0 | 5.5 | | 51.8 | 49.7 | 46.8 | 42.9 | 38.3 |
| | | | | | | | | |

Dimension

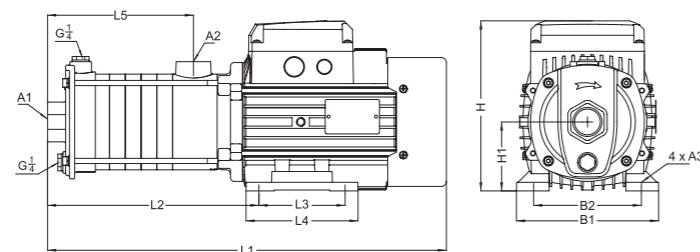

| Model | L1 | L2 | L3 | L4 | L5 | B1 | B2 | H | H1 | A1 | A2 | A3 |
|-------------|-----|-------|-----|-----|-------|-----|-----|-------|-----|----|----|-----|
| ECH(m)15-10 | 451 | 233.5 | 100 | 130 | 139.5 | 165 | 125 | 204.5 | 80 | G2 | G2 | Φ10 |
| ECH(m)15-20 | 510 | 222 | 125 | 150 | 139.5 | 180 | 140 | 217.5 | 90 | G2 | G2 | Φ10 |
| ECH15-30 | 560 | 272 | 125 | 150 | 189.5 | 180 | 140 | 247.5 | 90 | G2 | G2 | Φ10 |
| ECH15-40 | 616 | 336.5 | 140 | 180 | 230 | 205 | 160 | 224.5 | 100 | G2 | G2 | Φ12 |

Hydraulic Performance Curves

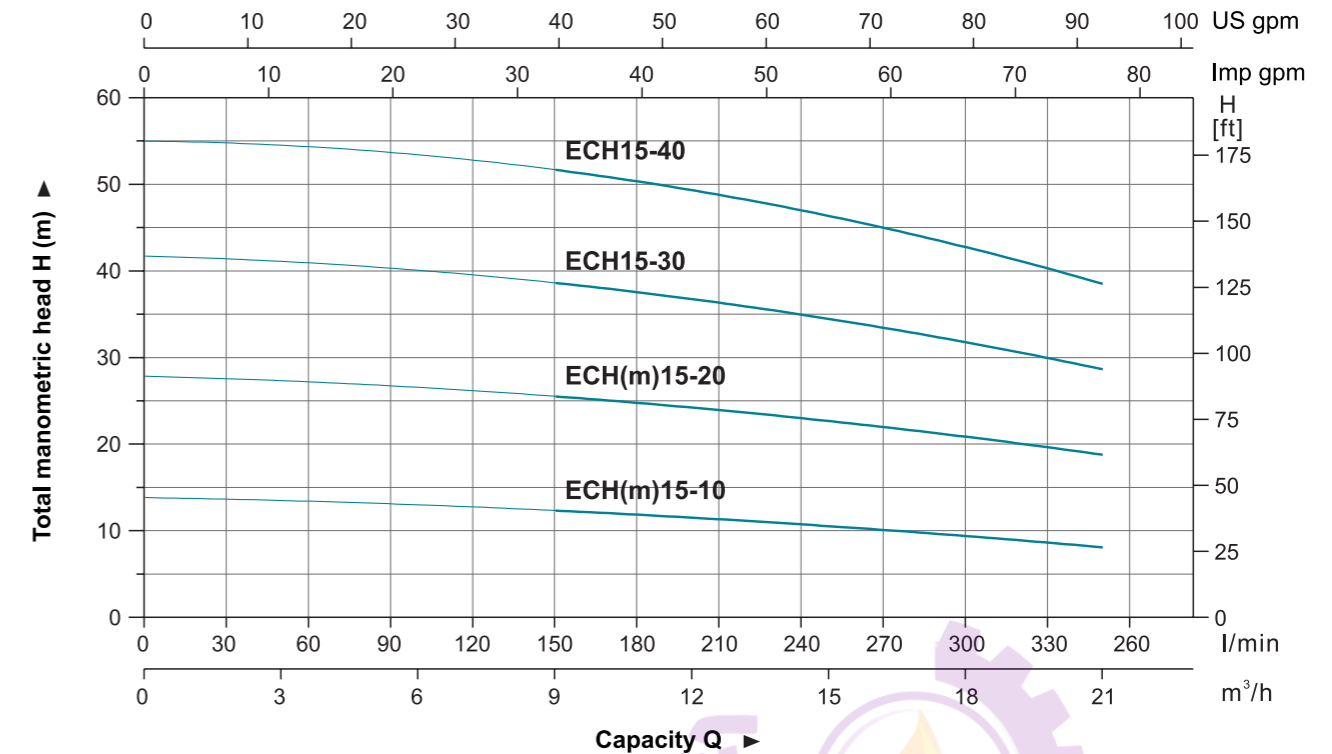

Materials Table

| No. | Part | Material |
|-----|-----------------|----------------|
| 1 | Fan cover | 08F |
| 2 | Fan | PP |
| 3 | Rear cover | ZL 102 |
| 4 | Rotor | |
| 5 | Bearing | |
| 6 | Terminal box | ZL 102 |
| 7 | Stator | |
| 8 | Front cover | Cast iron |
| 9 | Outlet body | Cast iron |
| 10 | Mechanical seal | Carbon/Ceramic |
| 11 | Diffuser | AISI 304 |
| 12 | Sleeve | AISI 304 |
| 13 | Impeller | AISI 304 |
| 14 | Pump body | Cast iron |

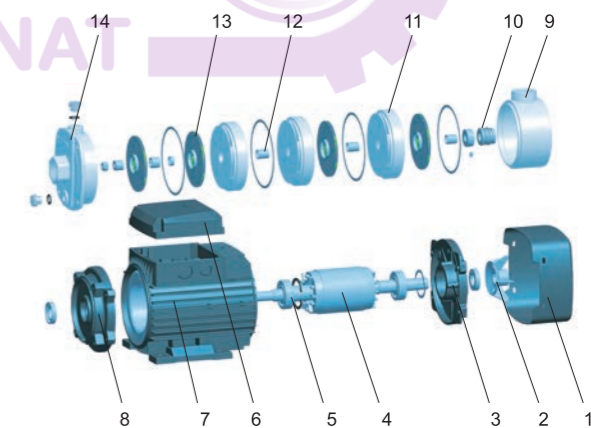

Package Information

| Model | GW (Kgs) | L (mm) | W (mm) | H (mm) | Quantity (PCS/20 TEU) |
|-------------|----------|--------|--------|--------|-----------------------|
| ECH(m)15-10 | 22.7 | 503 | 235 | 268 | 856 |
| ECH(m)15-20 | 30.3 | 557 | 245 | 283 | 659 |
| ECH15-30 | 32.2 | 618 | 245 | 283 | 620 |
| ECH15-40 | 39.6 | 687 | 245 | 290 | 504 |





Application

- It is applicable to household water supply, equipment support, pipeline pressurization, garden watering, vegetable greenhouse watering, fish farming and poultry raising, industrial and mining, water supply and drainage of enterprises and high-rise buildings, central air conditioner and centralized heating circulation system, etc.

Pump

- AISI 304 shaft
- Max. liquid temperature: +85°C
- Altitude: up to 1000 m
- Max. suction: 8 m
- Max. inlet pressure: limited by max. operating pressure

Motor

- Motor with copper winding
- Built-in thermal protector for single phase motor
- Insulation class: F
- Protection class: IP55
- Max. ambient temperature: +40°C

Identification Codes

ECH (m) 20 - 20

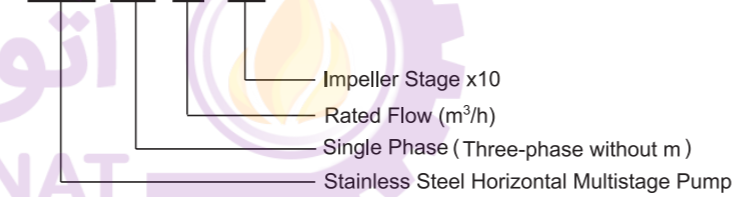

Technical Data

| Model | Power | | Q (m³/h) | 12 | 16 | 20 | 24 | 28 |
|-------------|-------|-----|--------------|------|------|------|------|------|
| | kW | HP | | | | | | |
| ECH(m)20-10 | 1.1 | 1.5 | H (m) | 12.1 | 10.8 | 9.5 | 7.8 | 5.7 |
| ECH(m)20-20 | 2.2 | 3 | | 26.1 | 24.4 | 22.4 | 19.8 | 17.2 |
| ECH20-30 | 4.0 | 5.5 | | 39.9 | 38.0 | 35.5 | 31.4 | 26.9 |
| ECH20-40 | | | | 52.7 | 50.1 | 45.9 | 40.3 | 34.0 |

Dimension

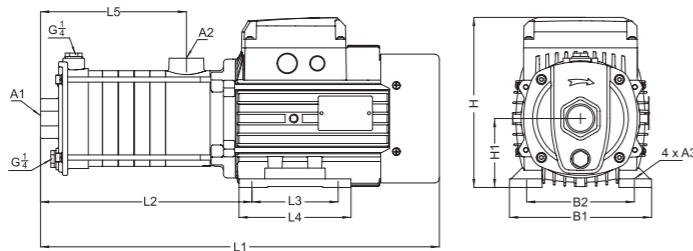

| Model | L1 | L2 | L3 | L4 | L5 | B1 | B2 | H | H1 | A1 | A2 | A3 |
|-------------|-------|-------|-----|-----|-------|-----|-----|-------|-----|----|----|-----|
| ECH(m)20-10 | 451 | 233.5 | 100 | 130 | 139.5 | 165 | 125 | 204.5 | 80 | G2 | G2 | Φ10 |
| ECH(m)20-20 | 510 | 222 | 125 | 150 | 139.5 | 180 | 140 | 217.5 | 90 | G2 | G2 | Φ10 |
| ECH20-30 | 570.5 | 291 | 140 | 180 | 184.5 | 205 | 160 | 224.5 | 100 | G2 | G2 | Φ12 |
| ECH20-40 | 616 | 336.5 | 140 | 180 | 230 | 205 | 160 | 224.5 | 100 | G2 | G2 | Φ12 |

Hydraulic Performance Curves

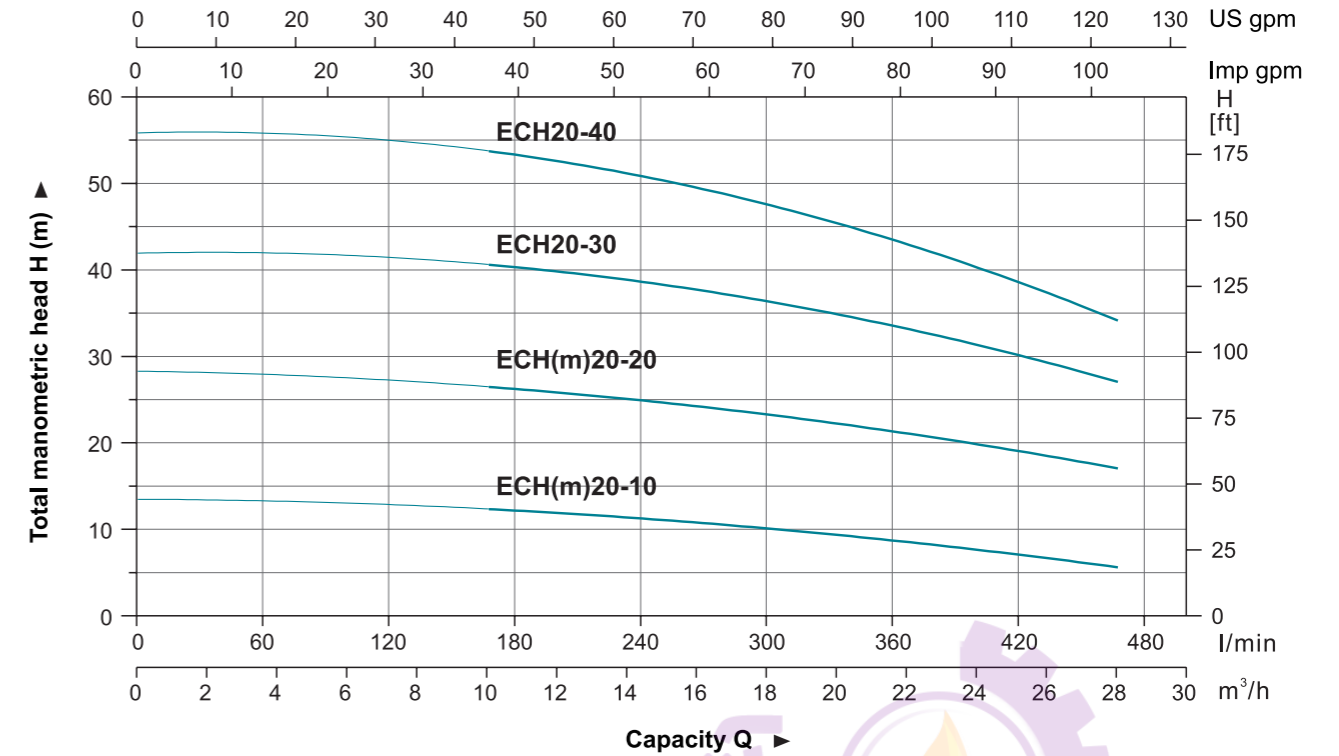

Materials Table

| No. | Part | Material |
|-----|-----------------|----------------|
| 1 | Fan cover | 08F |
| 2 | Fan | PP |
| 3 | Rear cover | ZL 102 |
| 4 | Rotor | |
| 5 | Bearing | |
| 6 | Terminal box | ZL 102 |
| 7 | Stator | |
| 8 | Front cover | Cast iron |
| 9 | Outlet body | Cast iron |
| 10 | Mechanical seal | Carbon/Ceramic |
| 11 | Diffuser | AISI 304 |
| 12 | Sleeve | AISI 304 |
| 13 | Impeller | AISI 304 |
| 14 | Pump body | Cast iron |

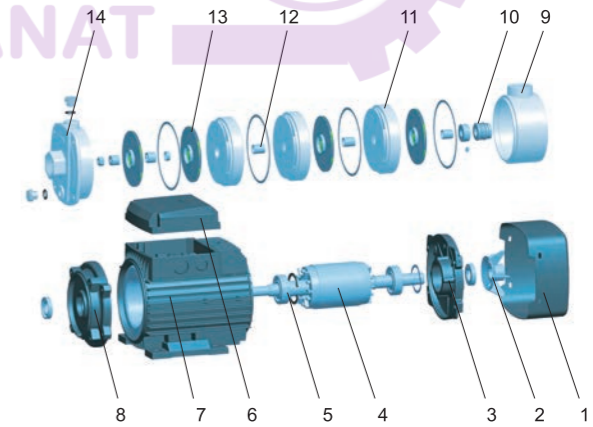

Package Information

| Model | GW (Kgs) | L (mm) | W (mm) | H (mm) | Quantity (PCS/20 TEU) |
|-------------|----------|--------|--------|--------|-----------------------|
| ECH(m)20-10 | 22.7 | 503 | 235 | 268 | 856 |
| ECH(m)20-20 | 30.3 | 557 | 245 | 283 | 659 |
| ECH20-30 | 38.9 | 687 | 245 | 290 | 513 |
| ECH20-40 | 39.4 | 687 | 245 | 290 | 504 |

